

14 IEXT101-2W & IEXT101C-2W

- ◀ 2 Wire, Long Reach Ethernet Extender
- ▶ Coaxial, Long Reach Ethernet Extender

- » Transmission 500 meter via 2 wire UTP or coaxial cable
- » 4KV Surge Protection for UTP or coaxial cable
- » Wide Operating Temperature Range, -20~75°C, for Use in Harsh Environments
- » EN50121-4, EN61000-6-2, EN61000-6-4, CE and FCC Certified

NEW



IEXT101C-2W

IEXT101-2W



Industrial-grade Ethernet extenders IEXT101-2W and IEXT101C-2W extend Ethernet transmission distance beyond the 100-meter limit of standard Ethernet. Paired devices, local and remote unit, operate in a point-to-point topology over 2-wires RJ-11 unshielded cable or Coaxial cable. This is the ideal solution to solve the problem of no electricity and save costs, it is designed for harsh environments and can be used in Industrial networks, traffic monitoring, safety automation applications and urban security, smart transportation systems. It is also suitable for many military or utility market applications where environmental conditions exceed commercial product specifications.

Features

- Long distance data transmission up to 500 meter via 2 wire UTP or Coaxial cable (See Figure 1 and Figure 2)
- Eliminates the need for any power supply at the remote side
- Quick deployment and easy maintenance

Specifications

Standard	IEEE 802.3	10Base-T	
	IEEE 802.3u	100Base-TX	
Hardware Interfaces	IEXT101-2W 2 Wire UTP Type	IEXT101-2W	2-pin Terminal Block for power input connector 1x RJ45 for LAN 10/100Base-TX Ethernet port 1x RJ11 (2wire UTP) for communication data between local and remote side The 2 wire UTP maximum distance is up to 500 meter.
		IEXT101C-2W BNC Coaxial Type	IEXT101C-2W
	Cable	LAN cable	Above Cat. 5e UTP or STP 4 wire cable. The maximum distance is up to 100 meter.
		Extension port	Cable : 1x RJ11 (2wire), above 24AWG. (IEXT101-2W 2 wire UTP type) The maximum distance is up to 500 meter.
	Extension port	Cable : 1x BNC Coaxial (IEXT101C-2W Coaxial type) The maximum distance is up to 500 meter.	

Industrial Ethernet Extender

LED	IEXT101-2W 2 wire UTP Type	IEXT101-2W	Power (Green) LAN Link/Active (Green) Line Speed/Link Active: 10M (Amber), 100M (Green)
	IEXT101C-2W BNC Coaxial Type	IEXT101C-2W	Power (Green) LAN Link/Active (Green) Line Speed/Link Active: 10M (Amber), 100M (Green)
Data rate	The line speed between Local unit and Remote unit will be 10M or 100M that depend on extension length that will be auto negotiation. The LAN speed is same with line speed (extension port). (Please ref Figure 1 and Figure 2)		
Operating Temperature	-20 ~ 75°C		
Storage Temperature	-40 ~ 85°C		
Humidity	10% - 95% (non-condensing)		
Power Supply	12/24/48VDC Input power (2pin Removable Terminal Block)		
Power Consumption	TBD		
Housing	Rugged Metal, IP30 Protection and fanless		
Dimensions	102.5 x 52 x 25mm (D x W x H)		
Weight	TBD		
Installation Mounting	Wall Mounting		
MTBF	TBD (MIL-HDBK-217)		
Certification			
EMC	CE (EN55032, EN55035)		
EMI (Electromagnetic Interference)	FCC Part 15 Subpart B Class A,CE		
Railway Traffic	EN50121-4		
Immunity for Heavy Industrial Environment	EN61000-6-2		
Emission for Heavy Industrial Environment	EN61000-6-4		
EMS (Electromagnetic Susceptibility) Protection Level	EN61000-4-2 (ESD) Level 3, Criteria B EN61000-4-3 (RS) Level 3, Criteria A EN61000-4-4 (Burst) Level 3, Criteria A EN61000-4-5 (Surge) Level 3, Criteria B EN61000-4-6 (CS) Level 3, Criteria A EN61000-4-8 (PFMF, Magnetic Field) Field Strength: 300A/m, Criteria A		
4KV Surge Protection	Supported for UTP or Coaxial cable		
Shock	IEC 60068-2-27		
Freefall	IEC 60068-2-31		
Vibration	IEC 60068-2-6		

Application

Figure1 : Extending Solution for IP Surveillance Systems

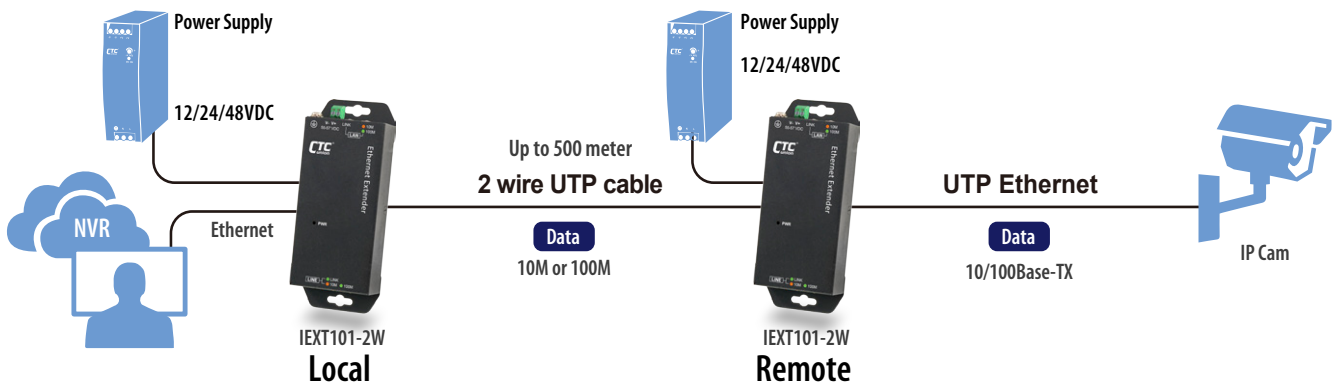

Industrial Ethernet Extender

14

Figure2 : Extending Solution for IP Surveillance Systems

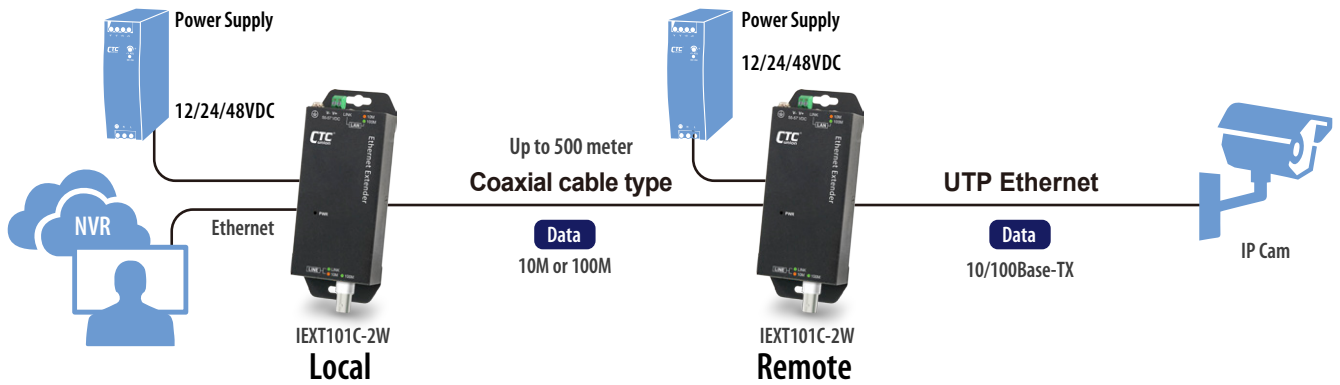

Dimensions

IEXT101-2W

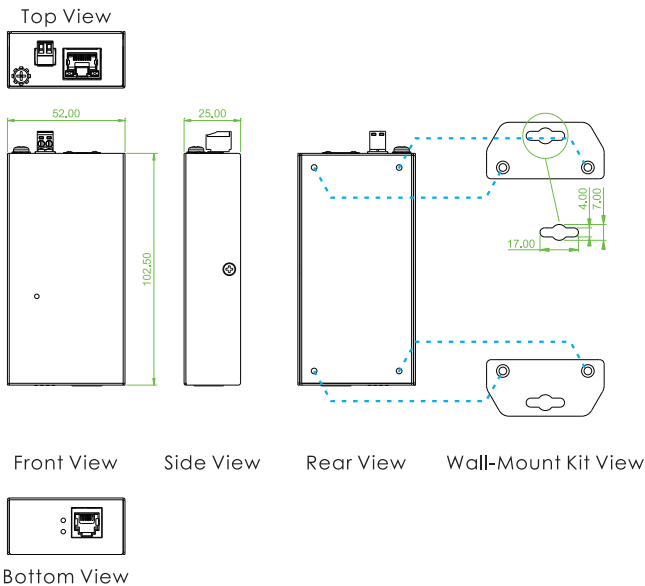

IEXT101C-2W

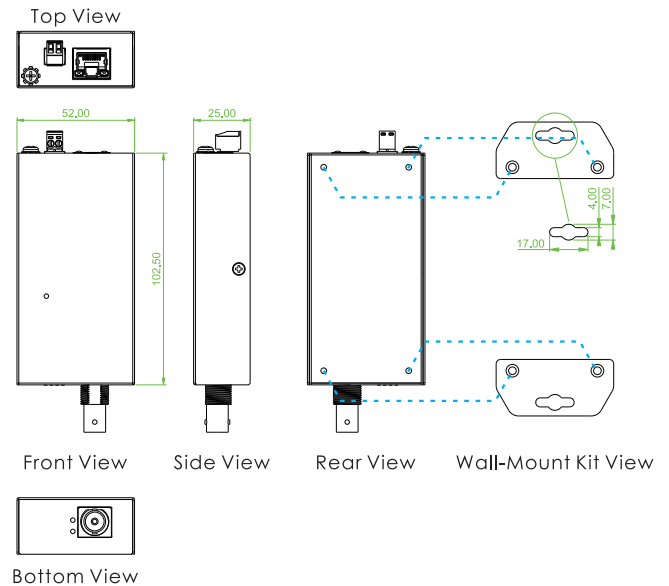

Ordering Information

Model Name	Ethernet port RJ45	Line Extension port RJ11	Input Power (Terminal block)	Certification		
	10/100Base-TX	10/100M (Up to 500meter)		Railway EN50121-4	EN61000-6-2 EN61000-6-4	CE FCC
IEXT101-2W	1	1	12/24/48VDC	V	V	V

Model Name	Ethernet port RJ45	Line Extension port BNC	Input Power (Terminal block)	Certification		
	10/100Base-TX	10/100M (Up to 500meter)		Railway EN50121-4	EN61000-6-2 EN61000-6-4	CE FCC
IEXT101C-2W	1	1	12/24/48VDC	V	V	V

Optional Accessories

Industrial Power Supply

MDR-20-24	Industrial Power, Input 85 ~ 264VAC/120 ~ 370VDC, Output 24VDC, 24W, -20 ~ 70°C
MDR-40-48	Industrial Power, Input 85 ~ 264VAC/120 ~ 370VDC, Output 48VDC, 40W, -20 ~ 70°C